

# Solidworks-装配体

# 设计→打印流程

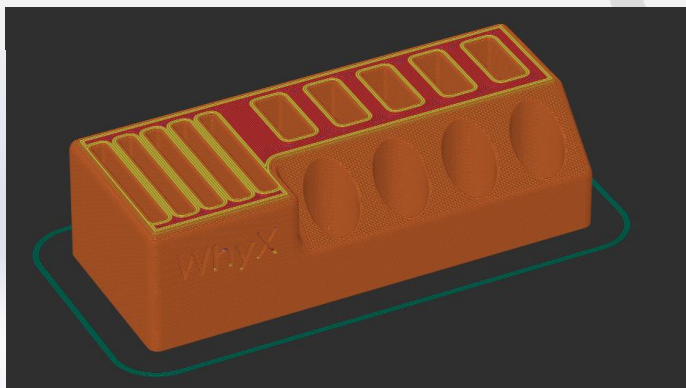
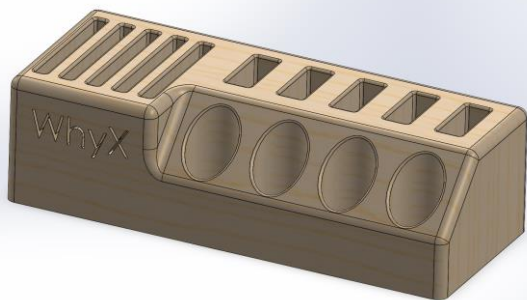
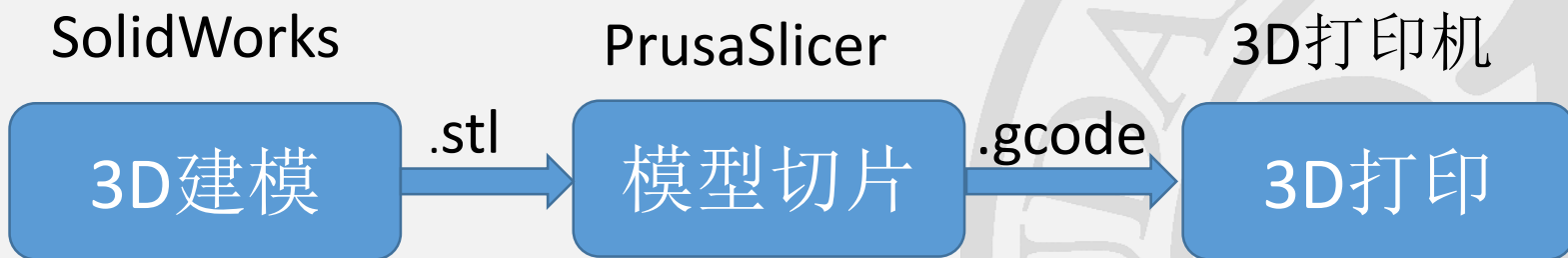

# SW的装配体

- 零件初步设计完成后
- 虚拟装配→检查合理性→修改模型
- 常见问题:
  - 安装孔位不匹配
  - 大小尺寸不匹配
  - 零件干涉



# 本篇内容简介

- 直接通过实战快速上手

- 涉及到的内容有：

  - eDrawing

  - 新建装配体

  - 配合

- 学会SW装配体

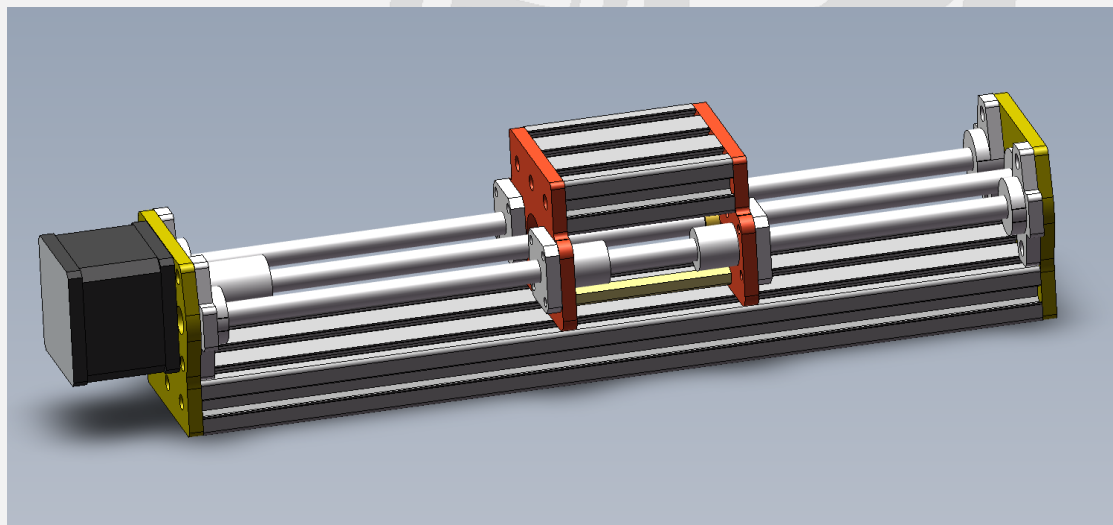

感谢B站 @喵星考拉 提供开源的滑台设计

<https://www.bilibili.com/video/BV1qV4y1d7sy>

# eDrawing

- 查看各种类型(stl,sw,dwg等)
- 格式转换(转exe)
- 查看零件组装方式
- 查找零件
- 测量零件尺寸
- 简单标注





装配体1.easm

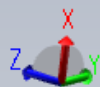
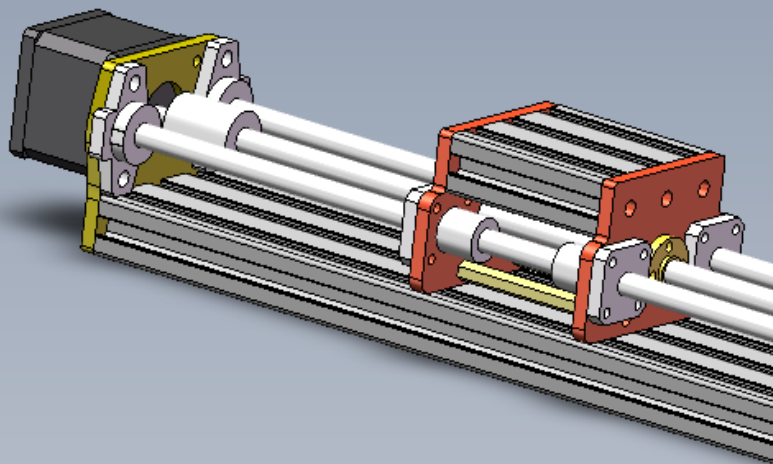

零部件



输入文字以过滤列表

- 铝型材底座300<1> "TUBE, SQUA
- 电机支撑板<1> (默认)
- 8卧式光轴座<1> (默认<按加工>)
- 8卧式光轴座<2> (默认<按加工>)
- 丝杆<1> (默认)
- 联轴器<1> (默认)
- 4240电机<1> (默认)
- phi8\_300 光轴<1> (默认)
- phi8\_300 光轴<2> (默认)
- 丝杆螺母<1> (默认)
- lmk8uu<1> "LMK8UU" (默认)



重设



动画



爆炸



移动



测量



截面



戳记

默认



标注



注解



零部件

# eDrawing

- 截面 视图
- 测量 (圆, 间距)

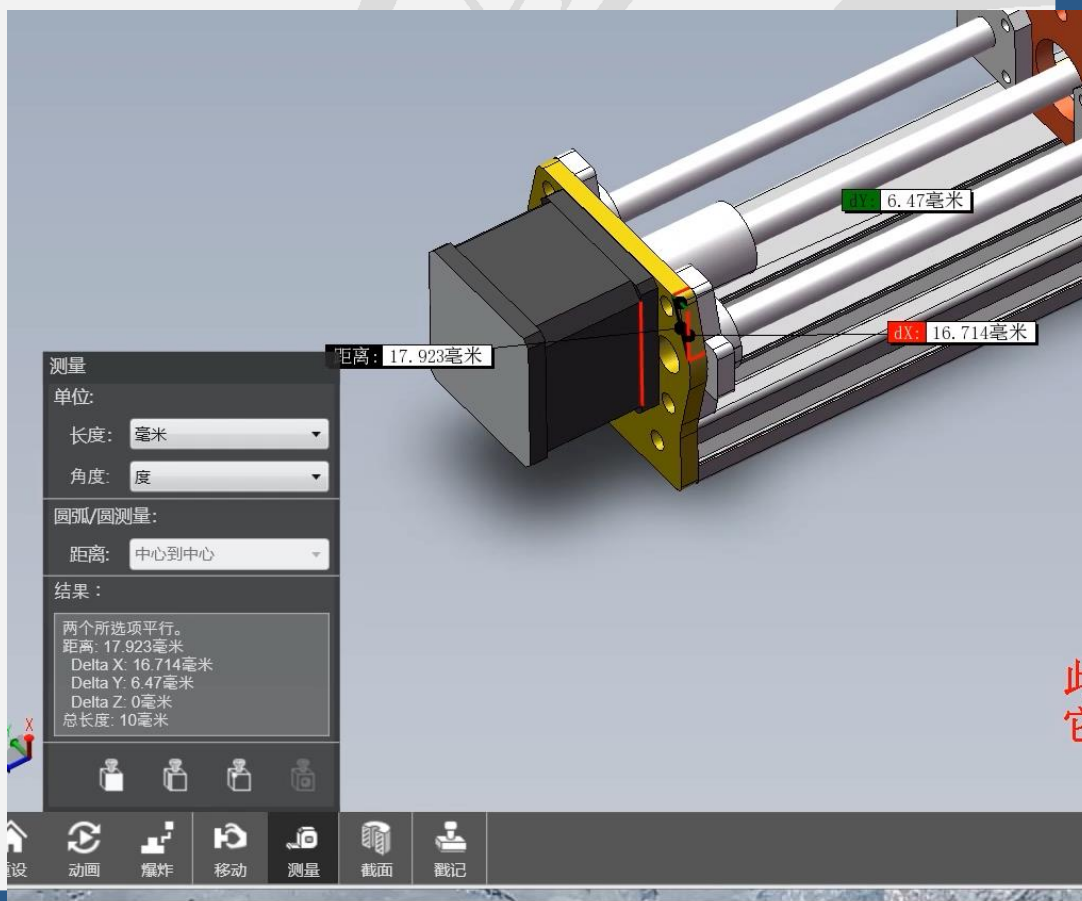
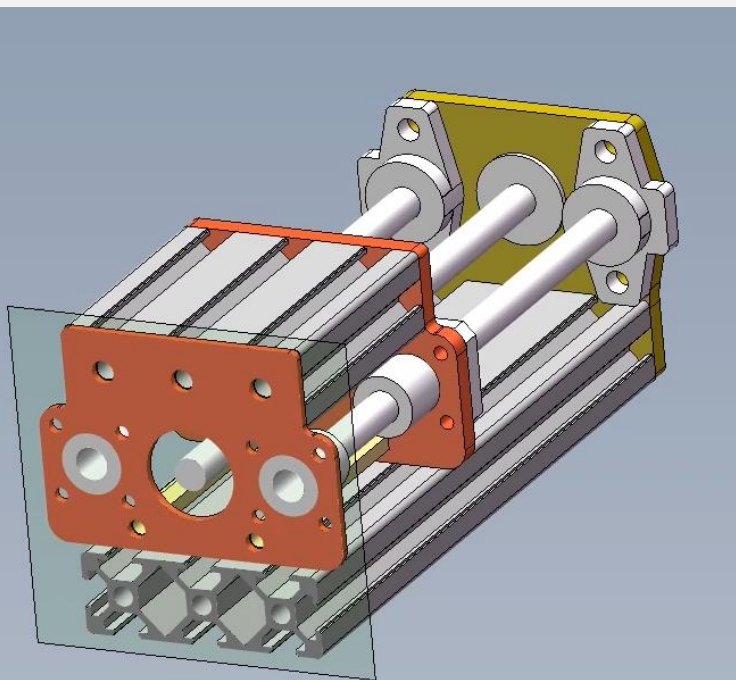



# 新建-装配体

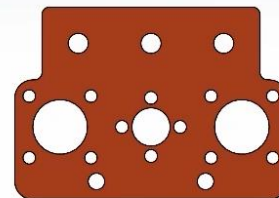
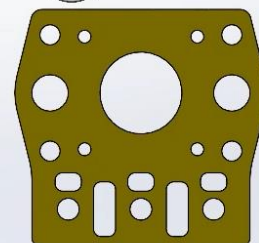
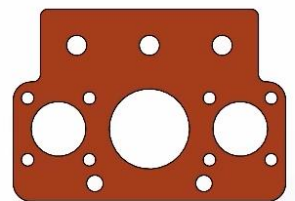
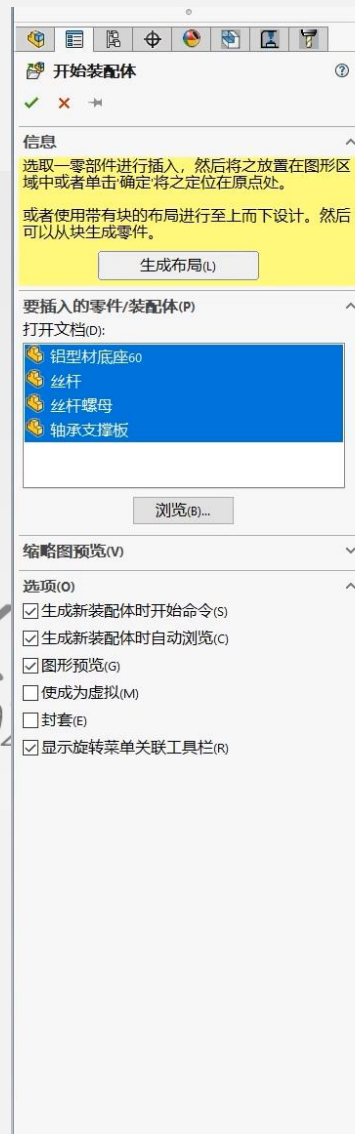
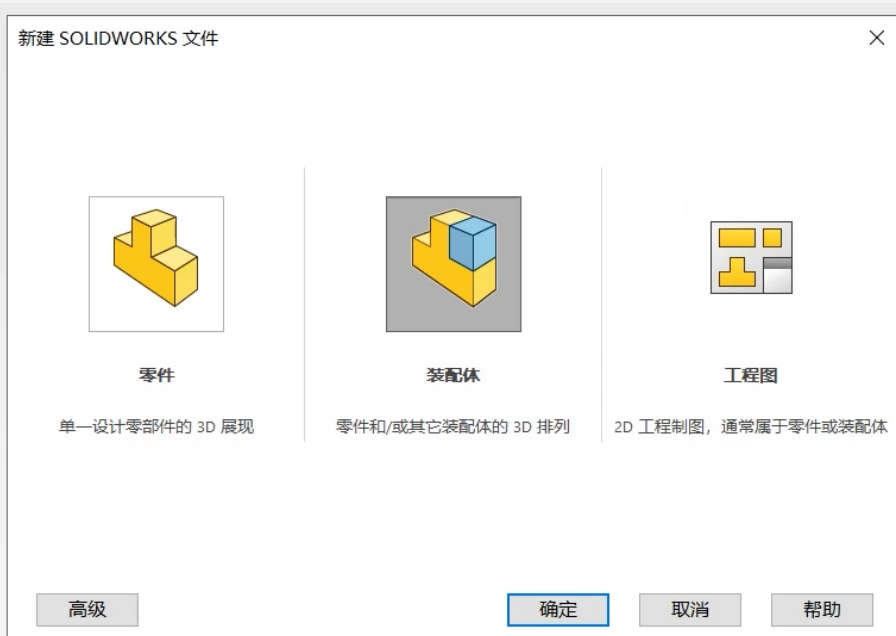



# 固定/浮动

- 第一个零件默认固定
- 右键-浮动/固定

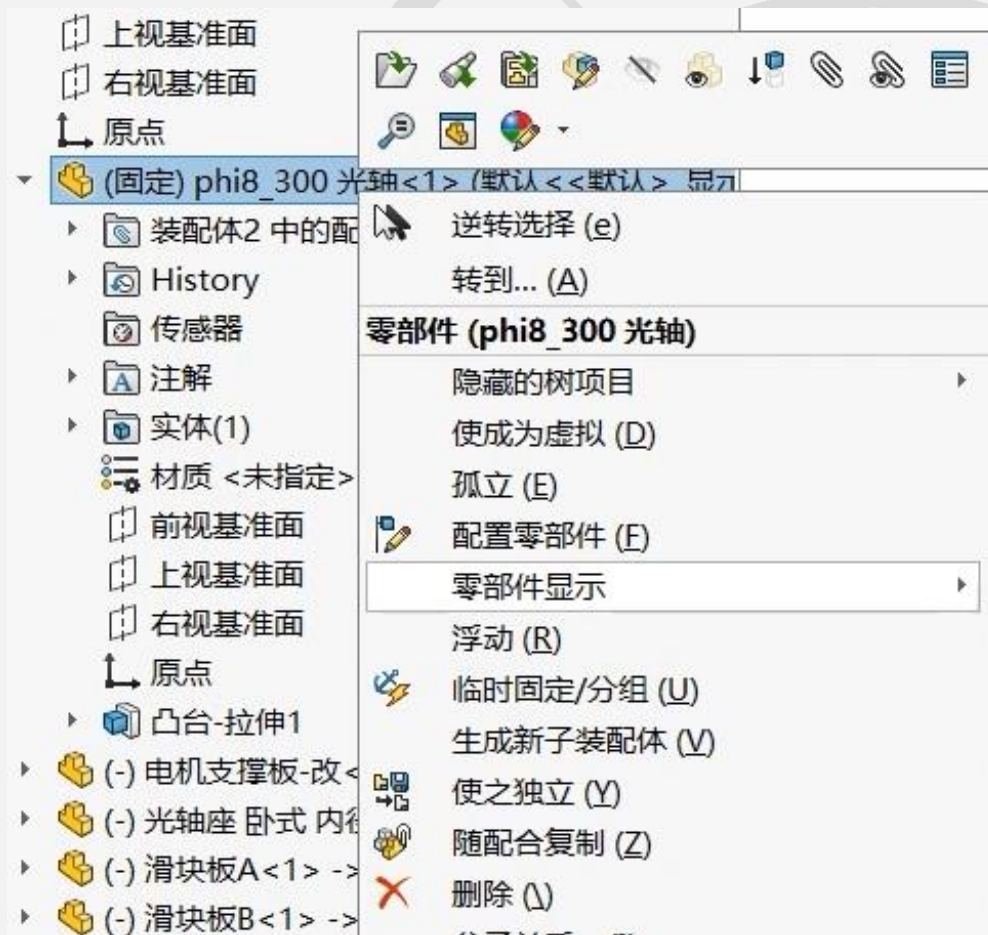

# 配合

- 3次配合=固定
- 平面与平面配合
- 圆(边线)与圆(边线)
- 曲面与曲面
- 平面与曲面

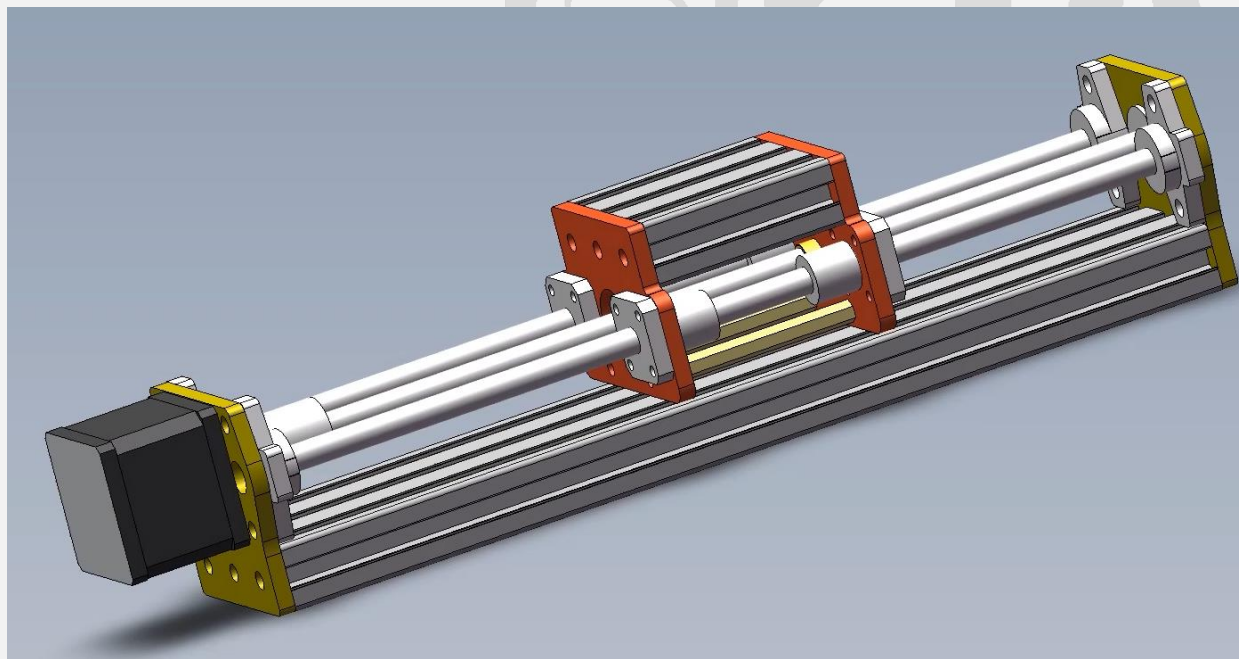

# 配合类型

- 选择配合类型
- 右键确认-开始新配合

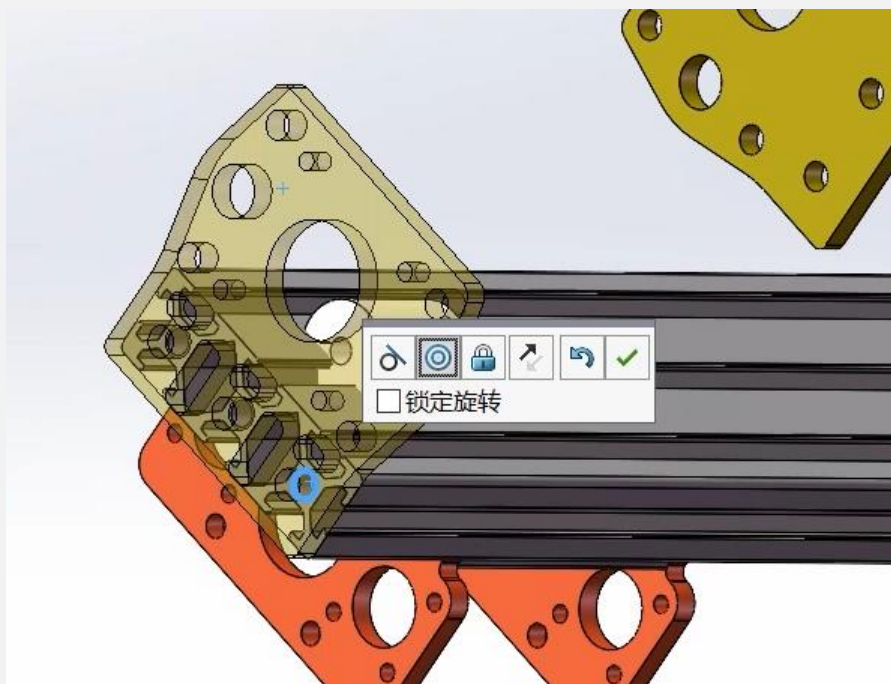

# 修改配合属性

■配合列表-找到-编辑

■对齐方向

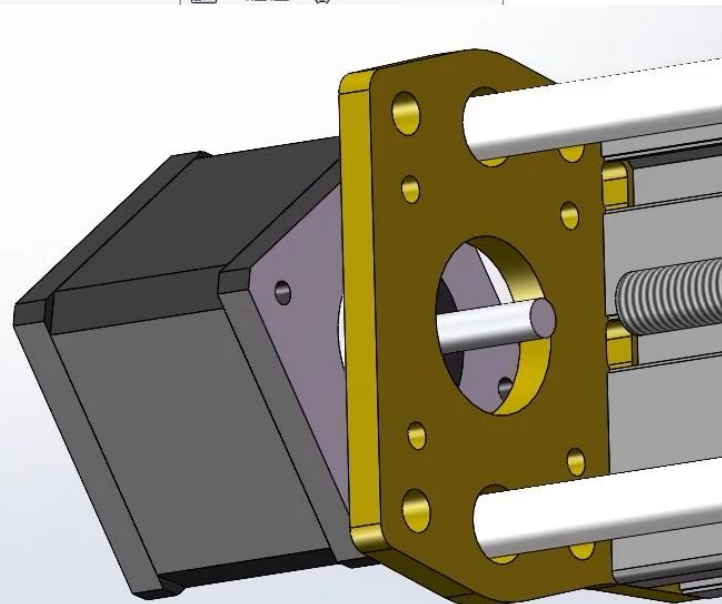
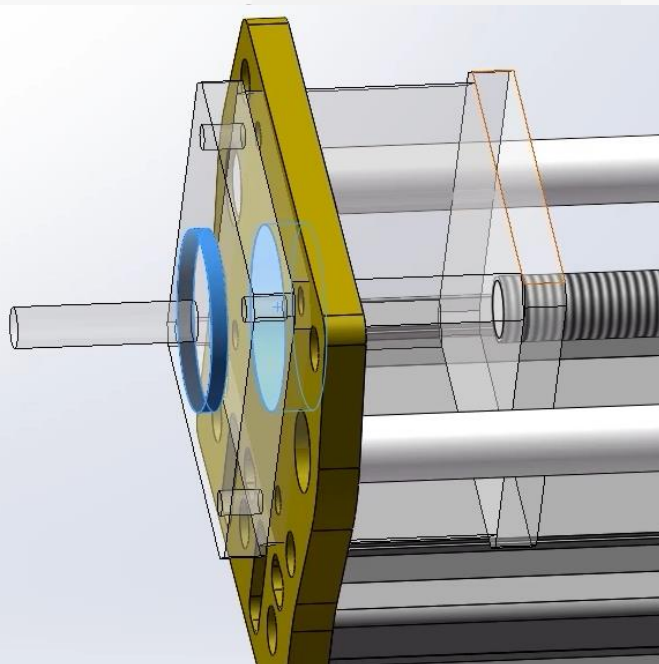
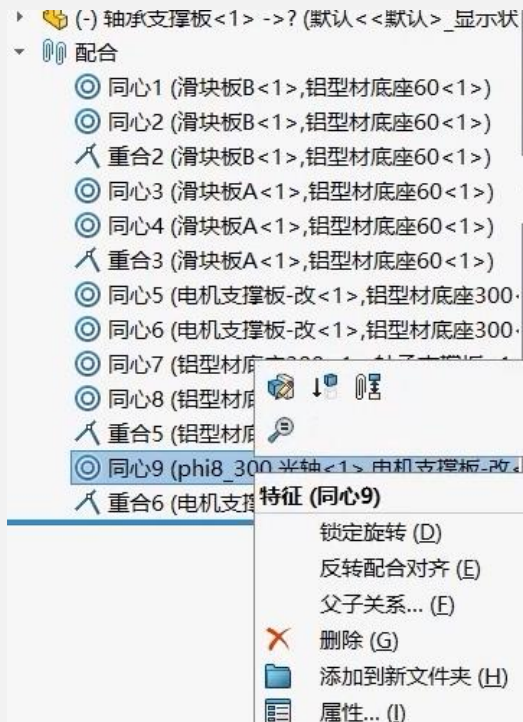
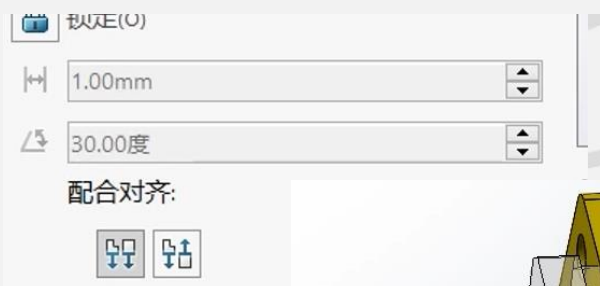

# 完成装配

- 将所有零件配合完成即可
- 检查移动时 是否有错（方向、转动）
- 保存后换eDrawing 检查

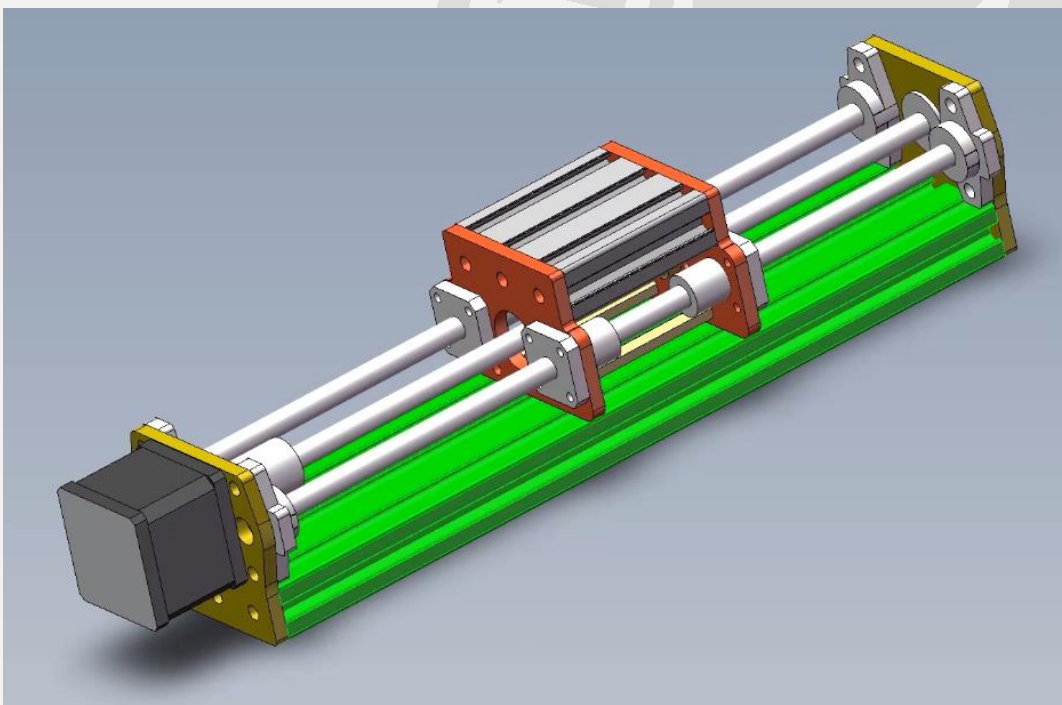



# 作业1滑台装配体

- 下载 光轴丝杆滑台-模型练习.zip
- 尝试按示范视频-生成装配体
- <https://www.bilibili.com/video/BV1Gw411k7kC>

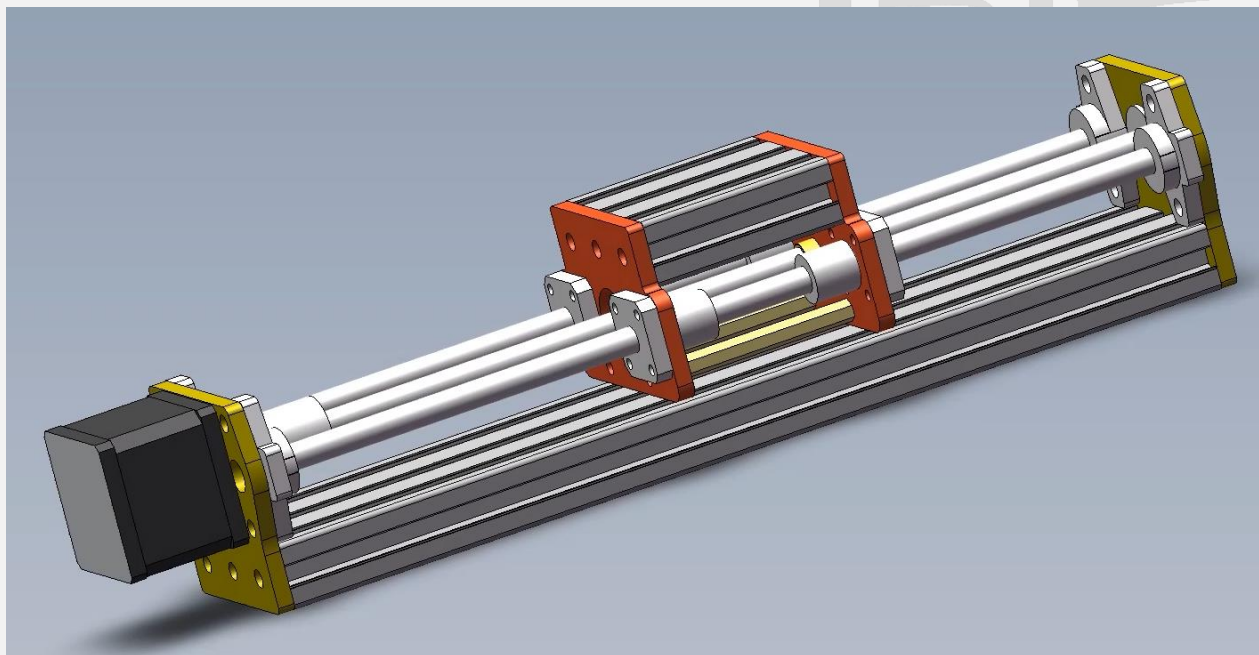

## 作业2（制作螺丝刀-装配体）

- 设计6.35批头螺丝刀,如图所示的装配体.(不需要一样)







---

# 期待大家的作品!

Fleeing is not a good way. If we can't beat them, we'd better join them.

感谢B站 @喵星考拉 提供开源的滑台设计

<https://www.bilibili.com/video/BV1qV4y1d7sy>